

## IT'S EASIER THAN YOU THINK

Driving through a roundabout is not as difficult as you may think. This is how you should do it:

- Stop for any pedestrians in the crosswalks as you approach or exit a roundabout. They have the right of way
- When approaching a roundabout slow your speed to about 15-20 miles per hour
- Chose which lane you need to be in and stay there. **DO NOT** change lanes while inside the roundabout



- Yield to vehicles already in the roundabout; wait for a gap in the traffic; then enter carefully

- Once you enter the roundabout, **KEEP MOVING**; do not stop or try to pass vehicles ahead of you



- Exit the roundabout in the direction of your destination

## DRIVING THROUGH A ROUNDABOUT

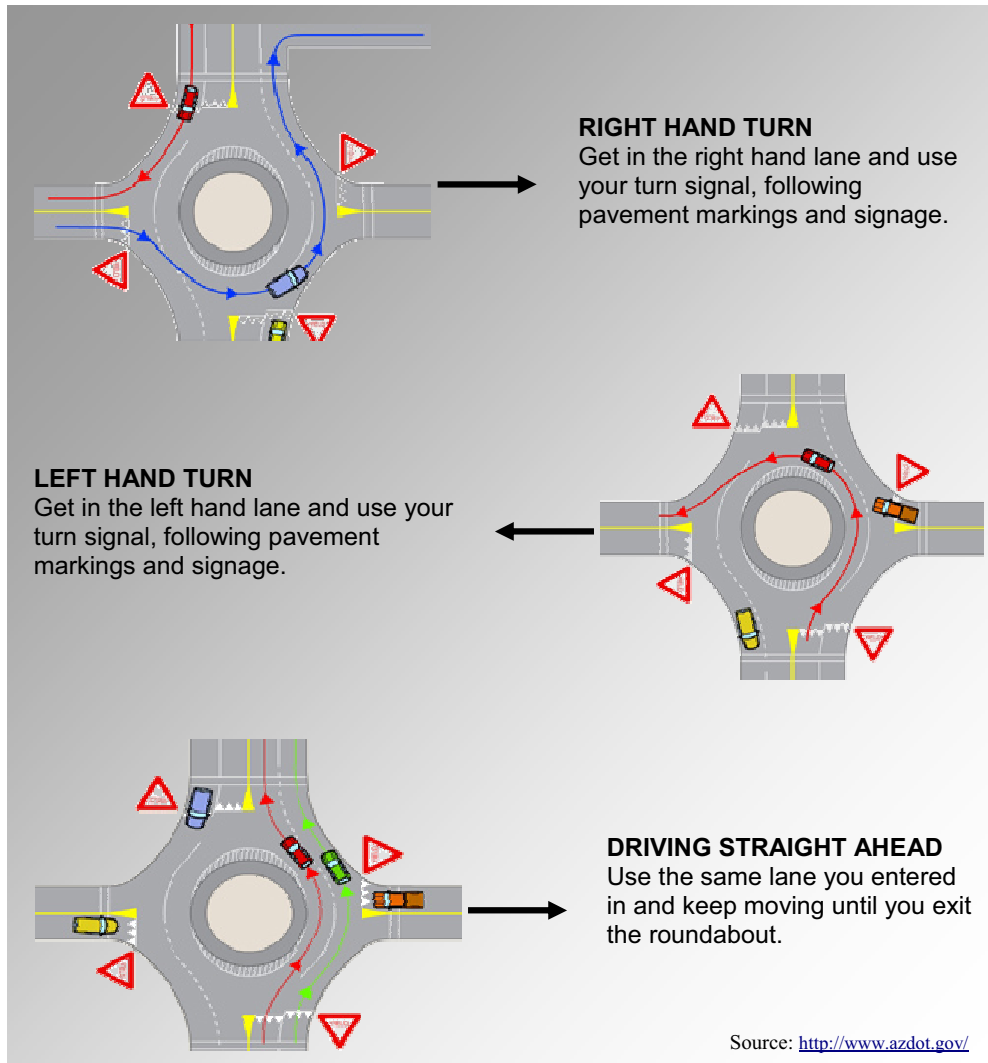

Source: <http://www.azdot.gov/>

## TIPS TO REMEMBER



- All roundabout traffic moves counterclockwise, which means you enter on the right

- All roundabouts in Virginia are either 1 lane or 2 lanes
- Though all roundabouts have different speeds posted, it is generally recommend that you drive no faster than about 23 mph

### Go S-L-O-W

**S**low down to about 15 mph when entering a roundabout

**L**et vehicles already in the roundabout go first

**O**bey ALL one-way traffic signs

**W**atch for pedestrians, bicyclists, emergency and large vehicles